



KEY GRIP SYSTEMS  
Development

# TRACK SYSTEMS

## Folding Beams



### Folding Beams for tracks

**KGS Development** beams are used to provide a strong and rigid foundation over rough terrain, on which to mount tracks and/or monotracks securely.

The time taken for set-up and levelling is considerably reduced thanks to the rigid structure and a very efficient system of connections (patent pending) to position the beams automatically to each other.

The folding concept of the design adjusts to the required track gauge and is also space saving when in transit.

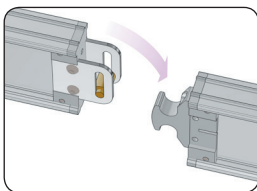

The male/female connectors automatically position the beams precisely in all types of conditions.

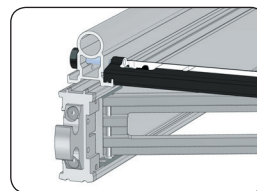

The beams profile is designed to securely locate to our Tracks and Monotracks.

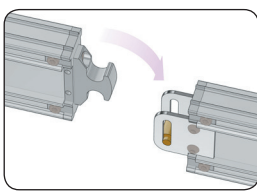

This system of symmetrical connections (Patent pending) allows beams to be joined without taking their direction into account.

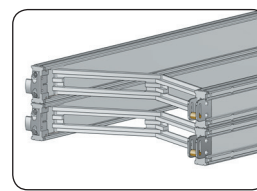

The stackable profiles allow load bearing to be increased, thus reducing space needed for storage and protecting the hinges during handling.



**KEY GRIP SYSTEMS**  
Development

# TRACK SYSTEMS

## Folding Beams

620 (24 1/2")

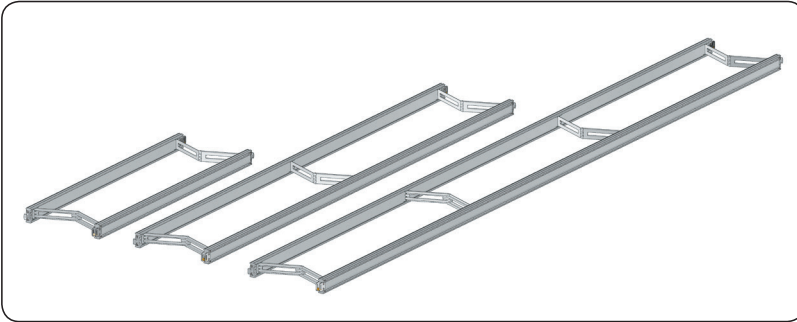

length  
2m (80")  
4m (160")  
6m (240")

1000 (39 3/8")

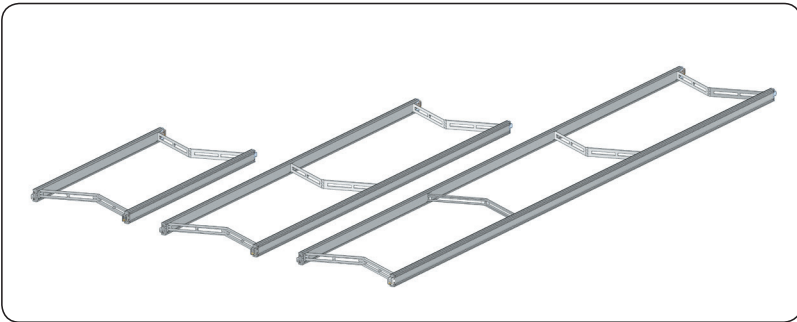

length  
2m (80")  
4m (160")  
6m (240")

1450 (57")

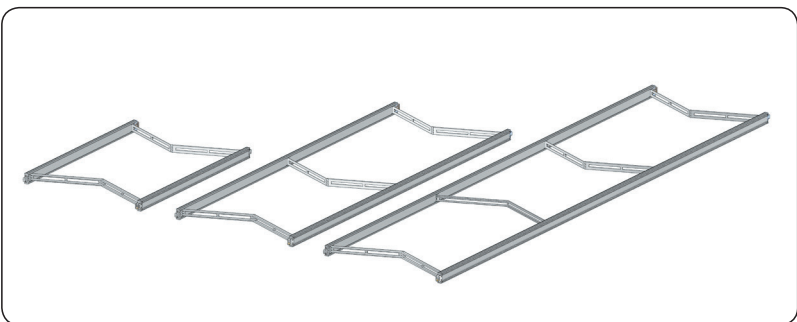

length  
2m (80")  
4m (160")  
6m (240")

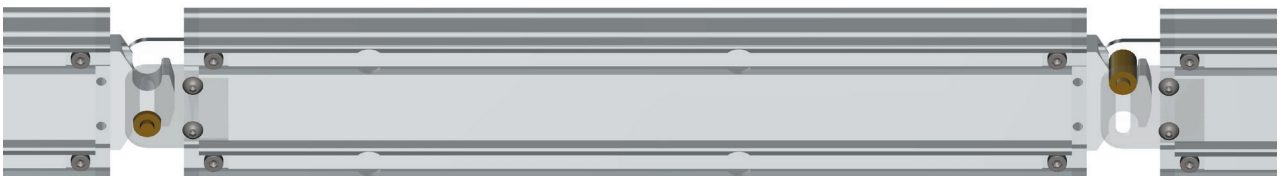





KEY GRIP SYSTEMS  
Development

# RAILS DROITS

## Fermes

620 mm

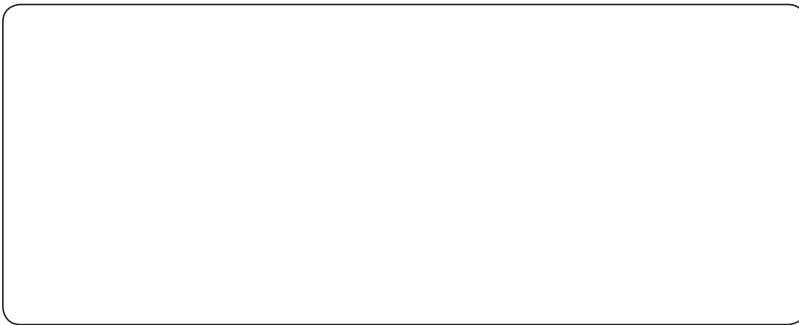

Longueur

2 m

4 m

6 m

1000 mm

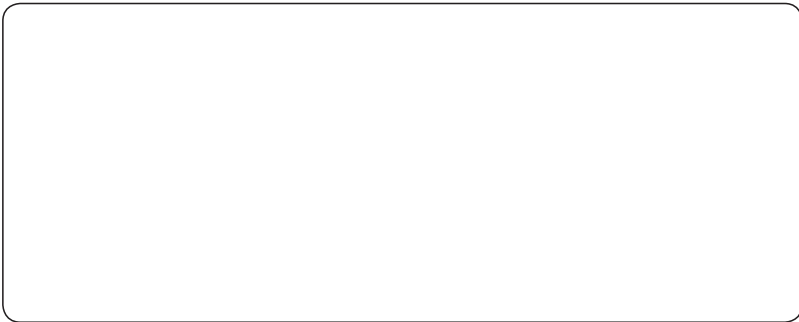

Longueur

2 m

4 m

6 m

1450 mm



Longueur

2 m

4 m

6 m